

Simon 400

Round USB
sockets for
furniture

simon

Simon|400

Always going from one place to another is something that has been done since prehistoric times. Something that today has reemerged strongly in our work environment.

And being able to work in the tranquility of that corner and for two hours in the meeting room, is have a million offices in one.

It is making a static routine into a more dynamic and functional one. It's choosing where to sit based on the day, whether you need to concentrate or where the sun hits in the afternoon. It is choosing where to sit based on the agenda, the meetings or what is happening today. have to do.

**It is returning to the origins.
It is to be again.**

**Simon presents Simon 400;
because the workplace changes every day.**





**SINGLE
SOLUTIONS**

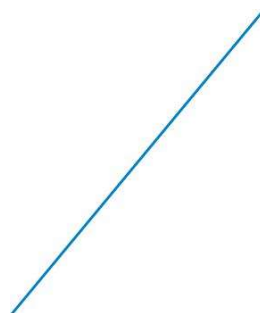

The Simon 400 series inside the desktop also offers connection sockets individuals o circular for panel office furniture.

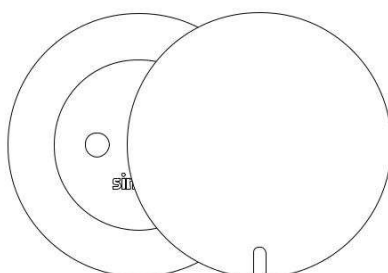
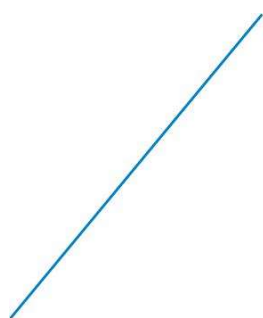

**mobile desktop for
a single user**



**Courtesy socket on
office furniture**



**Other applications and
domestic**

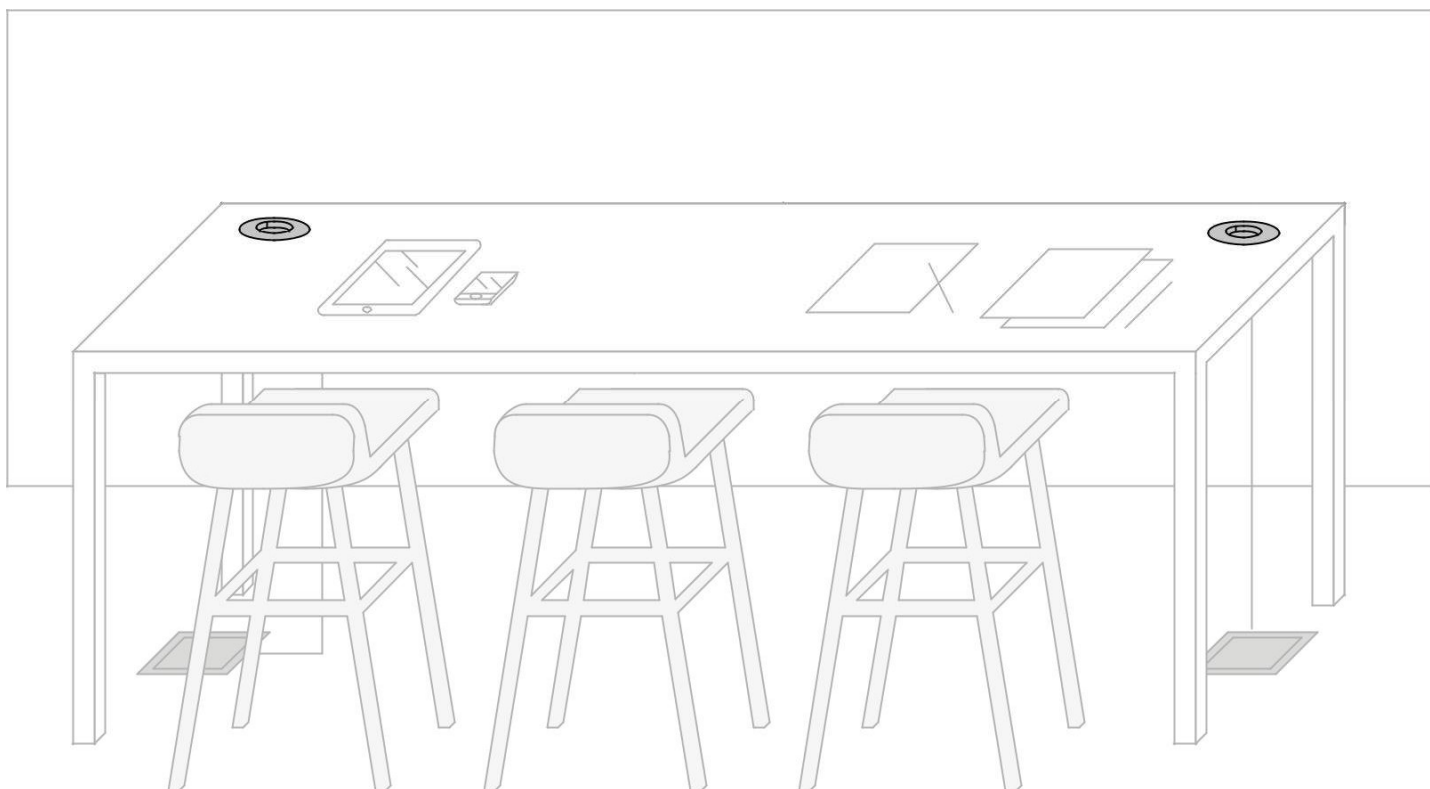

ASSEMBLED AND WIRED FAST AND SAFE



Assembled and wired

Supply in kit format. All the necessary components in a single reference.



Quick and easy installation

Wiring options with quick connector or free end.

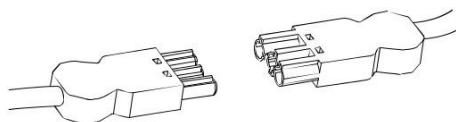

Simple installation from the top. Standard 54mm drilling hole.

Possibility of complete flushing by CNC.



Anti humidity

Drainage system at the bottom to eliminate liquid in case of fall

SINGLE SOLUTIONS



Single socket outlet
Schuko or French socket outlet. With
protective cap option.



USB type A+C charger
15.5W 5V / 3.1A | 18.0W 9V / 2.0A | 18.0W 12V / 1.5A
Compatible with QuickCharge technology. With
protective cap option.

SOCKET

Solutions that provide the most with the minimum space. To integrate into any workspace.







REFERENCE	DESCRIPTION	GAPS
43101000 - 130 - 138	Panelable power outlet with Schuko socket base with 20 cm hose ending at the free end	1



REFERENCE	DESCRIPTION	GAPS
43101002 - 130 - 138	Panelable power outlet with Schuko socket base with 20 cm hose ending in quick connector	1



REFERENCE	DESCRIPTION	GAPS
43101000 - 230 - 238	Panelable power outlet with hose terminated at the free end	1



REFERENCE	DESCRIPTION	GAPS
43101002 - 230 - 238	Panelable power outlet with hose ending in quick connector	1



REFERENCE	DESCRIPTION	GAPS
43100001 - 130 - 138	Accessory cover for panelable power outlets	1

USB A+C CHARGER

Solutions that provide the most with the minimum space. To integrate into any workspace.

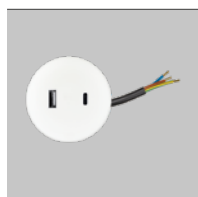

REFERENCE	DESCRIPTION	GAPS
43120000 - 130 - 138	White panelable USB A+C charger with 20 cm hose ending at the free end	1



REFERENCE	DESCRIPTION	GAPS
43120200 - 130 - 138	White panelable USB A+C charger with 20 centimeter hose ending in quick connector	1

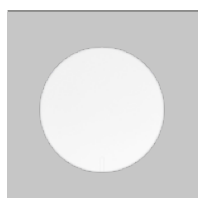

REFERENCE	DESCRIPTION	GAPS
43100002 - 130 - 138	USB A+C charger accessory cover	1

CHARACTERISTICS

TECHNIQUES

Plastic components made of thermoplastic materials, self-extinguishing and halogen-free, which guarantee the non-propagation of the flame due to fire and low toxicity in the event of smoke emission.

Claw working range: 10 to 50 mm

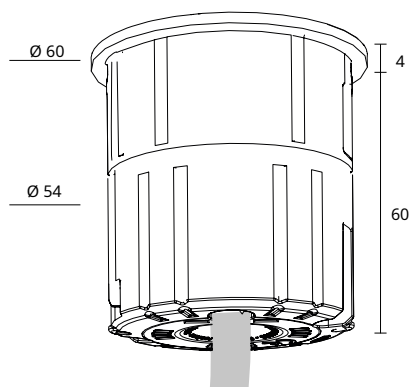

FINISHES



White RAL 9016



Black RAL 9005



FACILITY

Panelable sockets for installation in furniture

230V
30Hz

IP20

Facility: inside the table

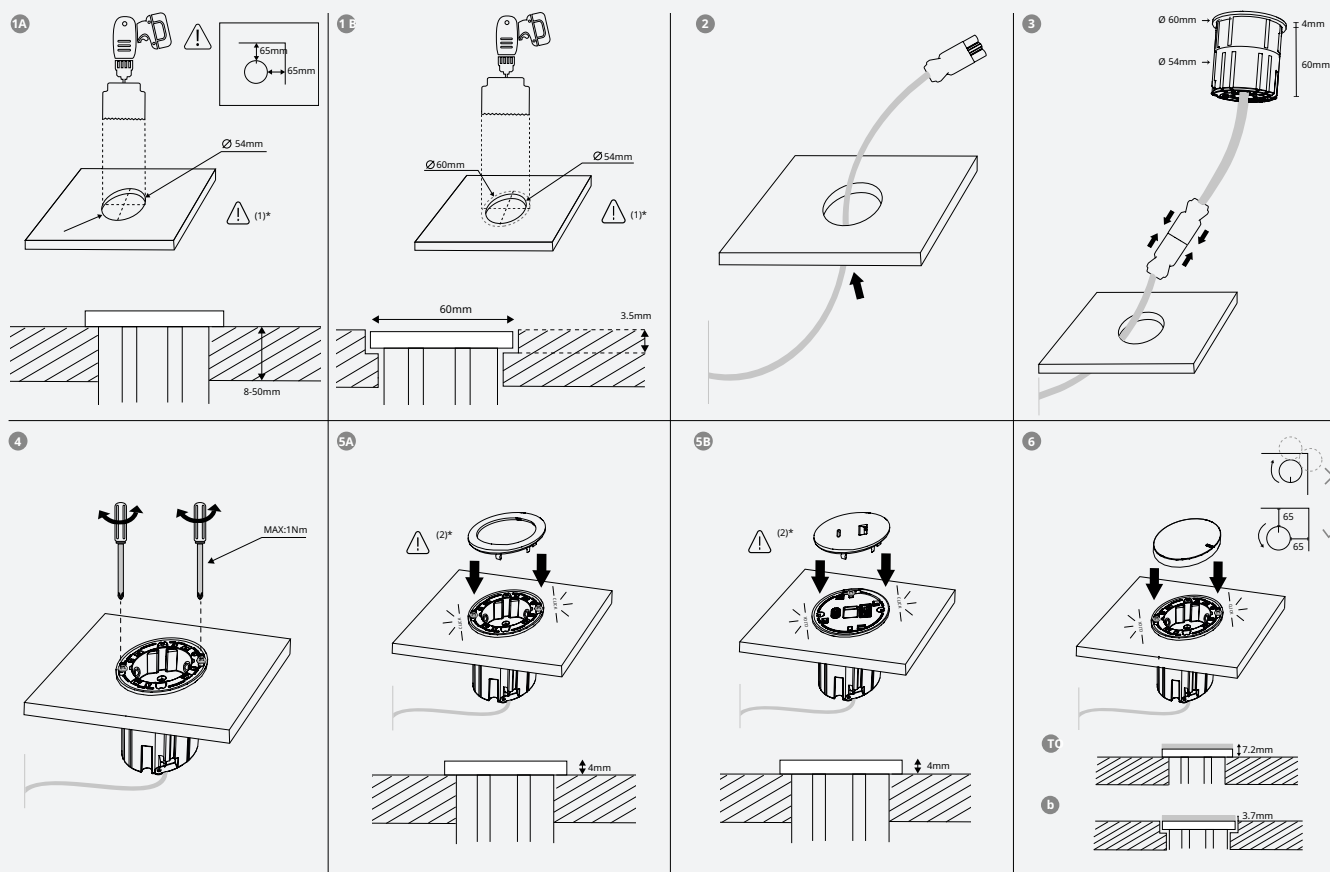

(1)* Make sure that the cut hole for installing the product does not coincide with the pitch of the reinforcing bars of the table.

(2)* Do not use the product without the trim ring correctly attached.

Panelable socket cover



230V
30HZ

IP20

Facility:inside the table

1A 43100001-13X

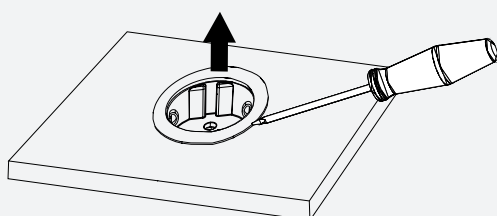

1B 43100002-13X

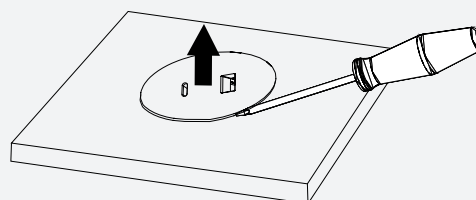

2A

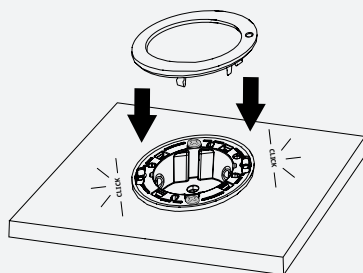

2B

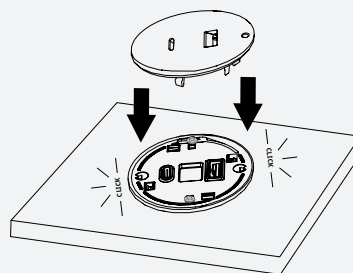

3A

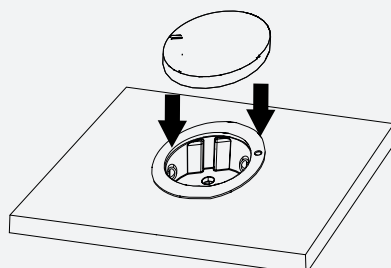

3B

